

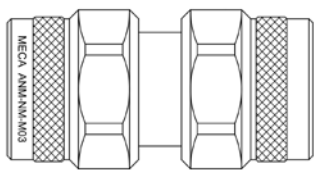

# Low PIM Adapters



| Series      | Freq (GHz) | Connector               | PIM (dBc) Typ | L" x OD"       |
|-------------|------------|-------------------------|---------------|----------------|
| ANM-NM-M03  | Hz - 12.4  | N-M to N-M              | <-165         | 1.60 x 0.812   |
| ARNM-NF-M01 | Hz - 11.0  | N-M to N-F              | <-160         | 1.45 x 1.32    |
| ANF-NF-M02  | Hz - 12.4  | N-F to N-F              | <-165         | 1.75 x 0.66    |
| ANM-SM-M03  | Hz - 18.0  | N-M to SMA-M            | <-160         | 1.29 x 0.812   |
| ANM-SF-M02  | Hz - 12.4  | N-M to SMA-F            | <-160         | 1.24 x 0.812   |
| ANF-SM-M02  | Hz - 11.0  | N-F to SMA -M           | <-160         | 1.36 x 0.67    |
| ANF-SF-M02  | Hz - 18.0  | N-F to SMA-F            | <-160         | 1.32 x 0.67    |
| ADM-DM-M01  | Hz - 8.0   | 7/16-M to 7/16-Ma       | <-165         | 1.37 x 1.88    |
| ADF-DF-M01  | Hz - 8.0   | 7/16-F to 7/16-F        | <-165         | 1.14 x 1.25    |
| ADM-DF-M01  | Hz - 8.0   | 7/16-M to 7/16-F        | <-165         | 1.57 x 1.25    |
| ANM-DF-M01  | Hz - 8.0   | N-M to DIN-F            | <-160         | 1.95 x 1.25    |
| ANF-DF-M01  | Hz - 7.5   | N-F to 7/16-F           | <-160         | 1.14 x 1.95    |
| ANF-DM-M01  | Hz - 8.0   | N-F to 7/16-M           | <-165         | 1.37 x 2.27    |
| ANM-DM-M01  | Hz - 8.0   | N-M to 7/16-M           | <-160         | 1.37 x 1.95    |
| ANF-SM-M01  | Hz - 12.4  | N-F to SMA-M            | <-165         | 1.60 x 0.82    |
| ANF-SF-M01  | Hz - 12.4  | N-F to SMA-F            | <-165         | 1.60 x 0.82    |
| ANM-SM-M01  | Hz - 12.4  | N-M to SMA-M            | <-165         | 1.60 x 0.82    |
| ANM-SF-M01  | Hz - 12.4  | N-M to SMA-F            | <-165         | 1.60 x 0.82    |
| ADM-SM-M01  | Hz - 8.0   | 7/16 DIN-M to SMA-M     | <-160         | 1.37 x 1.95    |
| ADM-SF-M01  | Hz - 8.0   | 7/16 DIN-M to SMA-F     | <-160         | 1.37 x 1.95    |
| ADF-SM-M01  | Hz - 8.0   | 7/16 DIN-F to SMA-M     | <-160         | 1.37 x 1.95    |
| ADF-SF-M01  | Hz - 8.0   | 7/16 DIN-F to SMA-F     | <-160         | 1.37 x 1.95    |
| ANM-MDM     | Hz - 14.0  | N-M to 4.1/9.5 M        | <-160         | 1.37 x 0.86    |
| ANM-MDF     | Hz - 14.0  | N-M to 4.1/9.5 F        | <-160         | 1.60 x 0.86    |
| ANF-MDM     | Hz - 14.0  | N-F to 4.1/9.5 M        | <-160         | 1.69 x 0.92    |
| ANF-MDF     | Hz - 14.0  | N-F to 4.1/9.5 F        | <-160         | 1.93 x 4.1/9.5 |
| ADM-MDM     | Hz - 8.0   | 7/16 DIN-M to 4.1/9.5-M | <-160         | 1.37 x 4.1/9.5 |
| ADF-MDM     | Hz - 8.0   | 7/16 DIN-F to 4.1/9.5-M | <-160         | 1.48 x 0.92    |
| ADM-MDF     | Hz - 8.0   | 7/16 DIN-M to 4.1/9.5-F | <-160         | 2.03 x 1.37    |
| ADF-MDF     | Hz - 8.0   | 7/16 DIN-F to 4.1/9.5-F | <-160         | 1.71 x 4.1/9.5 |



ANM-NM-M03

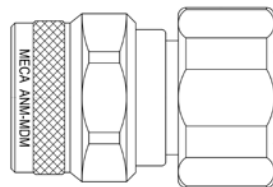

ANM-MDM

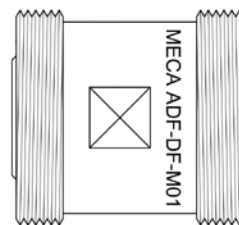

ADF-DF-M01

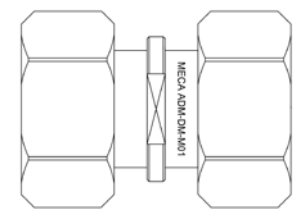

ADM-DM-M01